

www.wackergroup.com

VIBRATORY PLATE

DPU 5045H

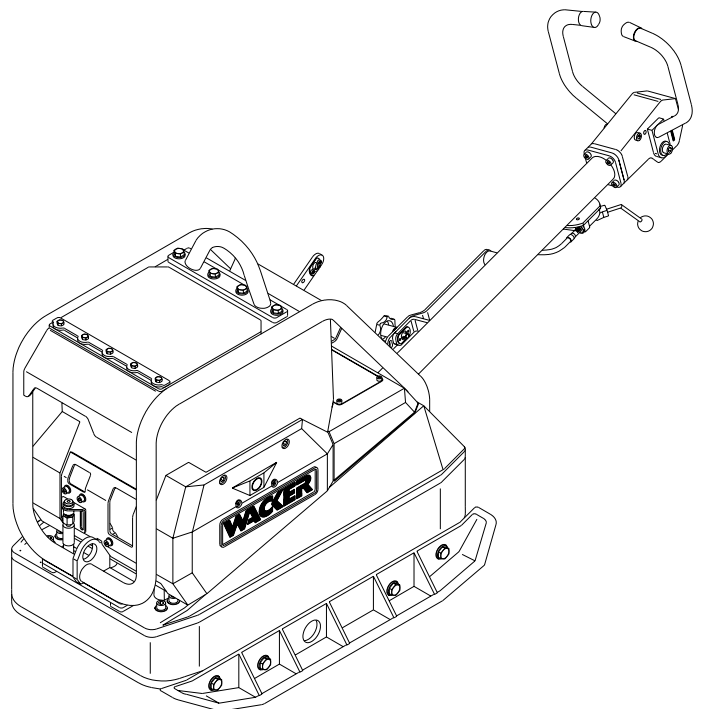

0200157en - 07.2000

0007862 100

Operator´s Manual

Type

Item no.

DPU 5045H

0007862 ...

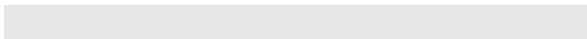
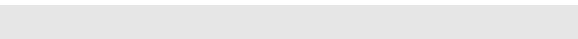
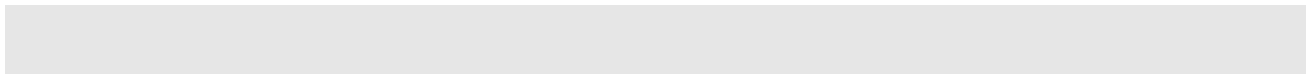

FOREWORD

For your own safety and protection from physical injury, carefully read, understand and observe the safety instructions.

Please operate and maintain your vibratory plate in accordance with the instructions in this instruction book. Your attention will be rewarded by trouble-free operation and high availability.

Defective machine parts are to be replaced as soon as possible.

SAFETY INSTRUCTIONS	6
General instructions	6
Operation	6
Safety checks	7
Maintenance	7
Transport	7
Maintenance checks	7
TECHNICAL DATA	8
DESCRIPTION	10
Field of application	10
Dimensions	10
Max. admissible inclination	10
Description of function	11
TRANSPORT TO WORK SITE, RECOMMENDATIONS ON COMPACTION	12
Transport to work site	12
Recommendations on compaction	12
OPERATION	13
Starting	13
Forward and reverse motion	13
Switching off	15
Compaction without extension plates	15
Emergency start by hand	15
Mechanical oil pressure control	16
Starting with external battery etc.	16
MAINTENANCE	17
Maintenance schedule	17
Engine oil	18
Battery	18
Hydraulic control	18
Exciter	20
Exciter V-belt	20
FAULTS	21
Forward speed too low	21
Reverse speed too low	21
No reverse motion	21
Loss of hydraulic oil	21
Battery-charge warning lamp does not go off	21
Engine does not start	21

EC - CONFORMITY-CERTIFICATE



23

SAFETY INSTRUCTIONS FOR THE USE OF VIBRATORY PLATES WITH COMBUSTION ENGINES

General instructions

1. Vibratory plates may only be operated by persons who
 - * are at least 18 years of age
 - * are physically and mentally fit for this job
 - * have been instructed in guiding vibratory plates and proved their ability for the job to the employer
 - * may be expected to carry out the job they are charged with carefully.
 The persons must be assigned the job of guiding vibratory plates by the employer.
2. Vibratory plates may only be used for compaction jobs. Both the manufacturer's operating instructions and these safety instructions have to be observed.
3. The persons charged with the operation of vibratory plates have to be made familiar with the necessary safety measures relating to the machine. In case of extraordinary uses the employer shall give the necessary additional instructions.
4. It is possible that this vibratory plate exceeds the admissible sound level of 89 dB (A). According to the rules for the prevention of accidents regarding emission of noise, the employees have to wear ear protection if the sound level reaches 89 dB (A) or more.

Operation

1. When starting a diesel engine with a starter crank make sure you have assumed a proper position with respect to the engine and that your hands are placed properly on the crank.
 -  **ATTENTION!** Only use the original engine manufacturer's safety starting crank.
To avoid a possible return kick, turn safety starting crank through with full force until the engine starts running.
2. The functioning of operating levers or elements is not to be influenced or rendered ineffective.
3. During operation the operator may not leave the control elements.
4. The operator has to stop the engine of the vibratory plate before going on breaks. The machine has to be placed such that it cannot turn over.
5. Stop engine before filling fuel tank. When refilling fuel tank, do not allow fuel to come into contact with the hot parts of the engine or spill onto the ground.
6. Do not smoke or handle open fire near this machine.
7. The tank lid must fit tightly. Shut off fuel cock, if available when stopping the engine. For long distance transports of machine operated by fuel or fuel - mixtures, the fuel tank has to be drained completely.
 -  **ATTENTION!** Leaky fuel tanks may cause explosions and must therefore be replaced immediately.
8. Do not operate the machine in areas where explosions may occur.
9. Make sure that sufficient fresh air is available when operating vibratory plates with combustion engines in enclosed areas, tunnels, adits and deep trenches.
10. During operation keep your hands, feet and clothes away from the moving parts of the vibraton plate. Wear safety shoes, and eye protection glasses in case of trench operation where falling sand stones maybe ejected.
11. When working near the edges of breaks, pits, slopes, trenches and platforms, vibratory plates are to be operated such that there is no danger of their turning over or dropping in.

12. Make sure the soil or subsoil to be compacted has a high enough load carrying capacity.
13. Use appropriate protective clothing while working or while carrying out maintenance work.
14. When traveling backwards the operator has to guide the vibration plate laterally by its guide handle so that he will not be squeezed between the handle and a possible obstacle. Special care is required when working on uneven ground or when compacting coarse material. Make sure of a firm stand when operating the machine under such conditions.
15. Vibratory plates are to be guided such that hand injuries caused by solid objects are avoided.
16. Vibratory plates have to be guided such that their stability is guaranteed.
17. Machines with integrated transport trolley may not be parked or stored on the trolley. This device has only been designed to transport the machine.

Safety checks

1. Vibratory plates may only be operated with all safety devices installed.
2. Before starting operation, the operator has to check that all control and safety devices function properly.
3. Immediately notify your supervisor or superintendent if you have determined defects in the safety devices or other defects which could endanger the safe operation of the machine or which could endanger the environment.
4. In case of defects jeopardizing the operational safety of the vibration plate, the machine has to be stopped immediately.
5. Process materials and operating fuels must be stowed away in receptacles or containers marked according to the respective manufacturers specifications.

Maintenance

1. Only use original spare parts. Modifications to this machine, including the adjustment of the maximum engine speed set by the manufacturer, are subject to the express approval of Wacker. In case of non-observance all liabilities shall be refused.
2. All drive units have to be switched off before carrying out maintenance jobs. Deviations from this are only allowed if the maintenance or jobs require a running engine.
3. When working on vibratory plates equipped with electric starter, disconnect battery before carrying out maintenance or repair jobs on the electric parts of the machine.
4. Remove pressure from hydraulic lines before working on them. Caution: take care when removing hydraulic lines, for the oil may be very hot (up. over 80° C). Precautions are to be taken to prevent oil from splashing into the operator's eyes.
5. As soon as maintenance and repair jobs have been completed all safety devices have to be reinstalled properly.
6. Do not hose down the machine with water after each use to avoid possible malfunctions. Do not use high pressure washers nor chemical products.

Transport

1. During transport, loading and unloading of vibration plates by means of lifting devices, appropriate slinging means or hooks have to be used on the lifting points provided for this purpose on the vibratory plate.
2. The load-carrying capacity of the loading ramps has to be sufficient and the ramps have to be secure such that they cannot turn over. Make sure that no one be endangered by machines turning over by slipping or by moving machine parts.
3. When being transported on vehicles, precautions have to be taken that vibration plates do not slip or turn over.

Maintenance checks

According to the conditions and frequency of use, vibratory plates have to be checked for safe operation at least once a year by skilled technicians, such as those found at Wacker-service depots and have to be repaired if necessary.

Please also observe the corresponding rules and regulations valid in your country.

		DPU 5045H
Item no.		0007862 ...
Forward/reverse speed	m/min:	0 to 22
Surface compaction performance	m ² /h:	to 900
Operating weight		
Without extension plates	kg:	387
With extension plates	kg:	410
With extension plates accesories	kg:	429
Power transmission		From drive engine directly to exciter unit via automatic centrifugal and V-belts
Exciter		
Vibrations	min ⁻¹ (Hz):	approx. 4150 (69)
Multigrade oil		SAE 10 W 40
Drive motor		Air-cooled single-cylinder 4 stroke diesel engine - with electric starter
Piston displacement	cm ³ :	413
Engine speed	min ⁻¹ :	2850 + 100
Nominal output	kW (PS):	6,2 (8,4)
Oil		SAE 10 W 40
Fuel		Diesel
Fuel consumption	l/h:	1,8
Tank capacity	l:	5,0
Electrical system		
Battery		Special WACKER-battery for vibro plates, 12 V - 55 Ah
Alternator		Rotary current generator with electronic regulator and rectifier
Charging rate max.	A:	26
Charging voltage	V:	14
Starter		Starter motor
D.C.	V:	12
Hydraulic control		
Hydraulic oil		Fuchs Renolin MR 520

The required sound specifications, called-for by the EC-Machine Regulations per Appendix 1, Paragraph 1.7.4.f, are

- sound pressure level at the operator's location $L_{pA} = 90 \text{ dB(A)}$
- sound power level $L_{wA} = 106 \text{ dB(A)}$

The sound values were determined according to ISO 3744 for the sound power level (L_{wA}) and, alternately, ISO 6081 for the sound pressure level (L_{pA}) at the operator's location.

The weighted effective acceleration value, determined according to ISO 8662, Part 1, is 12 m/s^2 .

The sound and vibration measurements were carried out and obtained with the machine working on crushed gravel at nominal engine speed.

Field of application

The application range of these machines reaches from the trench and surface compaction, even with semi-cohesive soils, to the vibration of interlocking paving stones and sett pavements.

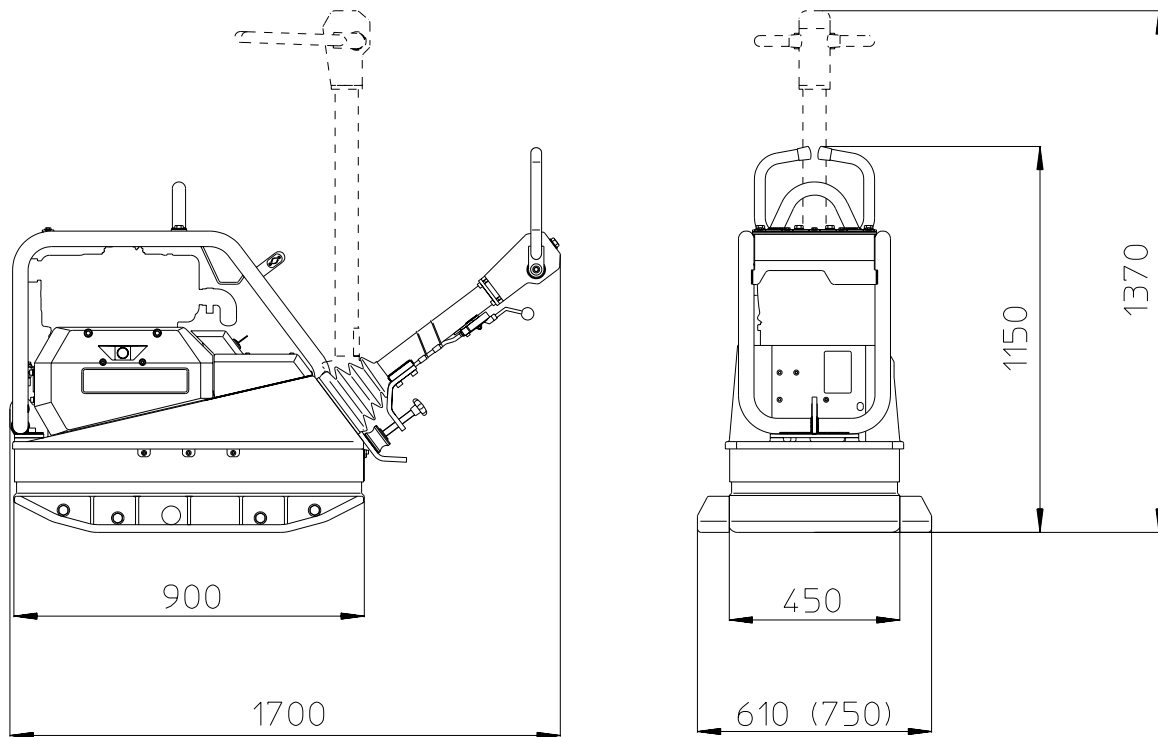
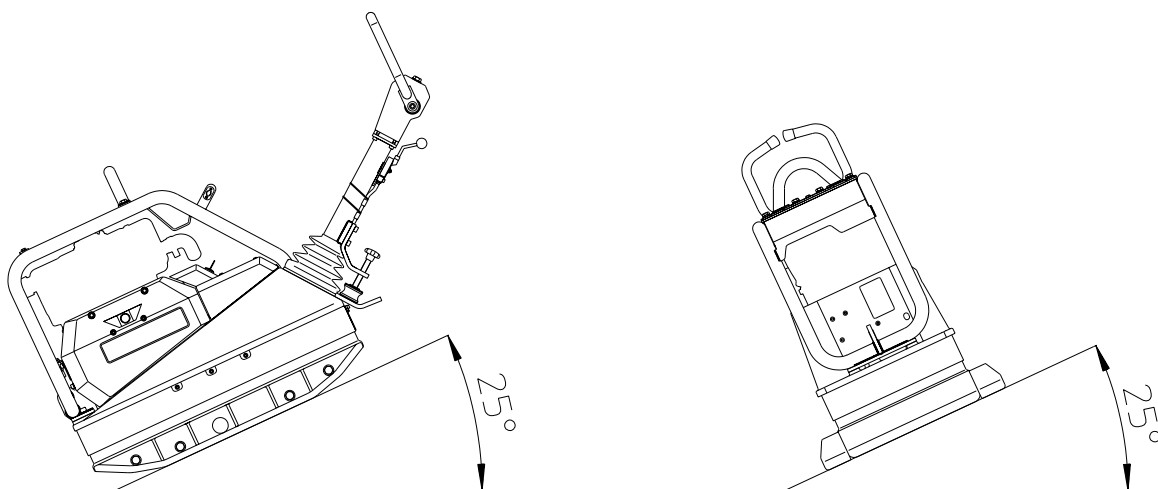
Dimensions**Max. admissible inclination**

Description of function

The vibration required for compaction is produced by the exciter (13) which is firmly joined to the lower mass (5). This exciter (13) is designed as a central vibrator with aligned vibrations. Such a principle permits the direction of vibration to be changed by turning the eccentric weights (15). In this way an infinitely variable transition between vibration in forward motion (Fig. 1), at standstill (Fig. 2) and in reverse motion (Fig. 3) is possible. This process is hydraulically controlled with the operating control handle (6) on the centre pole head (7).

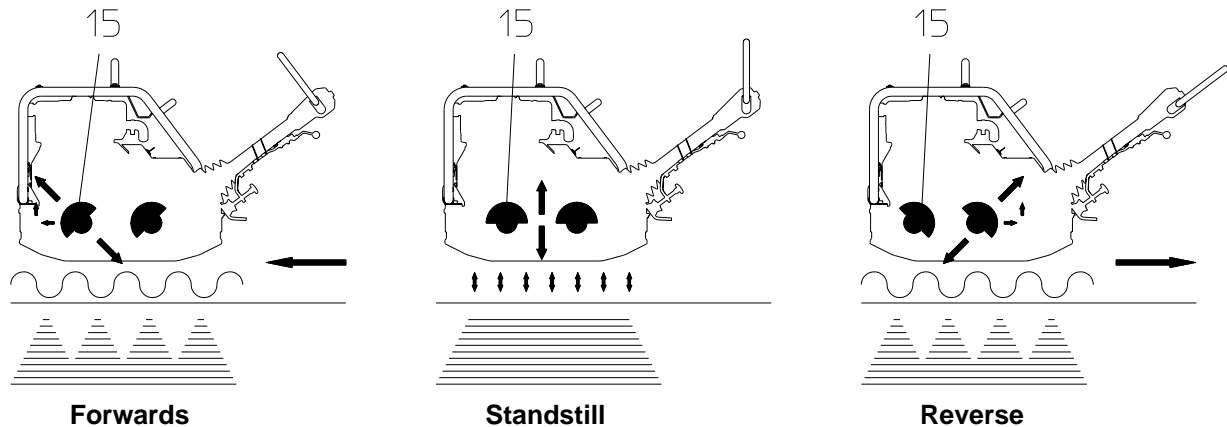

The drive engine (1) anchored to the upper mass (4) drives the exciter (13). The torque is transmitted by means of a friction connection through the centrifugal clutch (11) and the exciter V-belt (12).

The centrifugal clutch (11) interrupts flow of power to the exciter (13) at low engine speed and thus permits perfect idling of the drive engine (1).

The automatic V-belt pulley (10) combined with the centrifugal clutch (11) ensures optimum tension of the exciter V-belt (12) during operation and relief of the tension of the exciter V-belt (12) when the machine is being relocated or transported.

Moreover, the automatic V-belt pulley (10) automatically adapts to the V-belt flanks in line with the wear and thus makes the entire drive from the engine (1) to the exciter (13) maintenance-free.

The speed of the drive engine (1) can be infinitely varied by remote control on the throttle control lever (8). The upper (4) and lower (5) masses are connected to each other by 4 vibration-damping rubber metal shock mounts (14). This damping system prevents the very high frequencies from being transmitted to the upper mass (4). As a result the functionality of the drive engine (1) is retained in spite of the high compaction performance.

The drive engine (1) works on the diesel principle; it is started electrically by a pinion starter (3), draws in the combustion air through an air filter, dry (9) and is air-cooled.

To facilitate the starting procedure (at very low temperatures, with hand start) the drive engine (1) has an automatic decompression mechanism (2). It ensures that compression is very low during the cranking operation but steadily increases after a few revolutions when it then switches over to full compression.

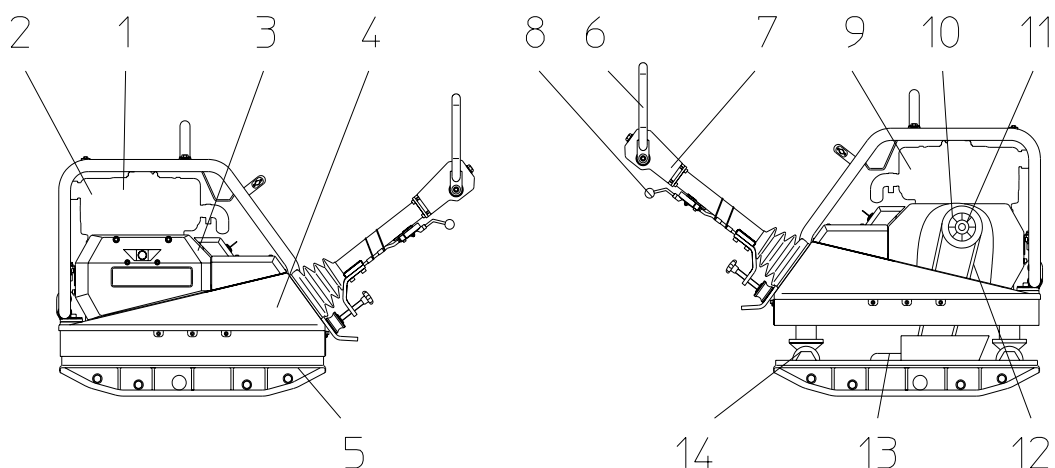

Transport to work site

Conditions:

- To transport the vibration plate, only use suitable lifting equipment with a minimum load-bearing capacity of 500 kg.
- Always switch off engine before transporting the machine!
- Only attach suitable tackle at the central lifting point (18a) provided. The central lifting point is located exactly above the centre of gravity of the machine. The central lifting point can be displaced rearwards (18b), given an application in which the height of the machine is of importance (torque wrench setting = 85 Nm).
- During transport on the loading area of a vehicle, tie down the vibration plate using the lugs (17).

Note: Also overve the regulations in safety instructions.

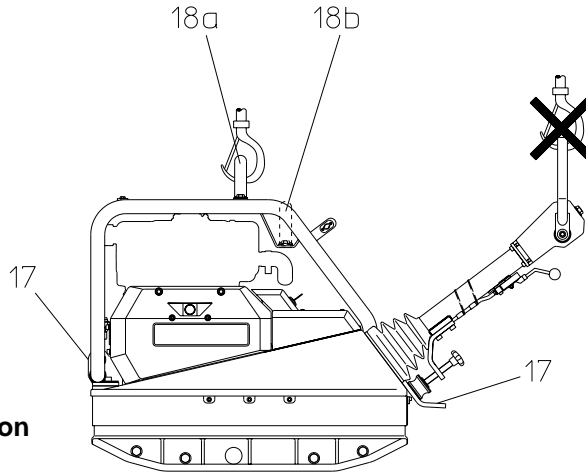

Recommendations on compaction

Ground conditions

The max. compaction depth depends on several factors relating to the ground condition, such as moisture, grain distribution etc.

It is therefore not possible to specify exact .

Recommendation: In each case determine the max. compaction depth with compaction tests and soil samples.

Compaction on slopes

The following points are to be observed when compacting on sloped surfaces (slopes, embankments):

- * Only approach gradients from the bottom (a gradient which can be easily overcome upwards, can also be compacted downwards without any risk).
- * The operator must never stand in the direction of descent (see chapter "safety instructions").
- * The max. gradient of 25° must not be exceeded.

ATTENTION! A tilt in excess of this angle could lead to a stopping of the engine due to the automatic low oil shut-off system. A restarting of the engine can only take place after the valve lever at the oil filter housing has been actuated once.

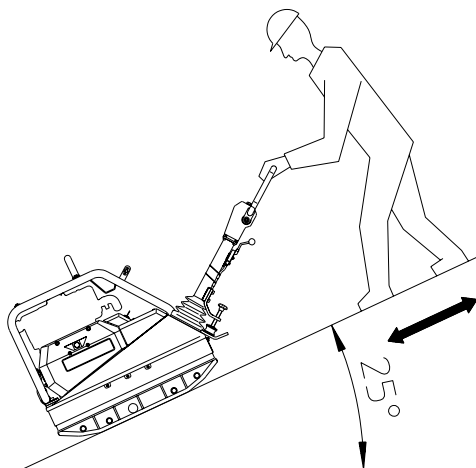

Right !

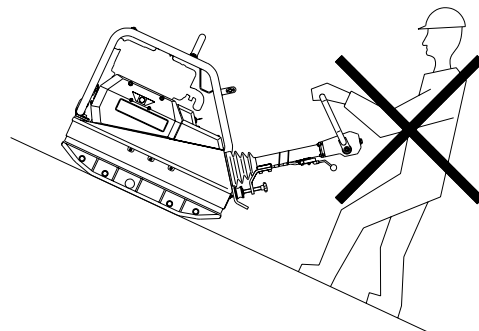

Wrong !

Starting

Conditions:

- Oil: Check oil level on oil dipstick (21), if necessary top up with HD brand oil SAE 10 W 40 using the filler nozzle (19).
- Fuel: When pouring diesel fuel into the fuel nozzle (20), maintain absolute cleanliness. Impurities in the fuel can cause breakdowns in the injection system and premature clogging of the fuel filter.
- Air filter: Clean air filter dry, dusty conditions.

Once these points have been observed, you can start the engine as follows:

1. Turn the throttle control lever (8) clockwise into full load position.
2. In extreme cold also activate the automatic decompression (2).
3. Turn ignition switch key (22) to operating position; then push in starter button and hold until engine is running.

ATTENTION! Wait until the engine stops before repeating the starting procedure.

4. Turn throttle control lever (8) into idling position, allow engine to warm up for 7 minutes at idling speed.

Note: Do not activate automatic decompression lever while the engine is running.

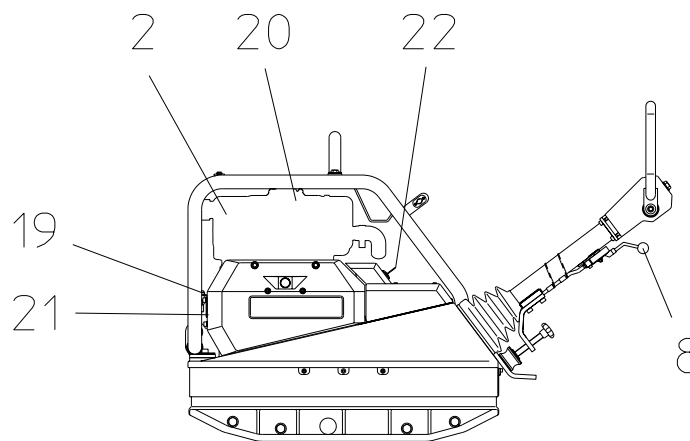

Forward and reverse motion

The engine speed can be infinitely varied on the throttle control lever (8).

The direction of travel is determined with the shift lever (6).

Depending on the position of the shift lever (6), the vibration plate compacts in forward direction, at standstill or in reverse direction.

The forward and reverse speeds can be varied by selecting intermediate positions of the shift lever (6) or the machine can be employed for particularly intensive compaction at standstill.

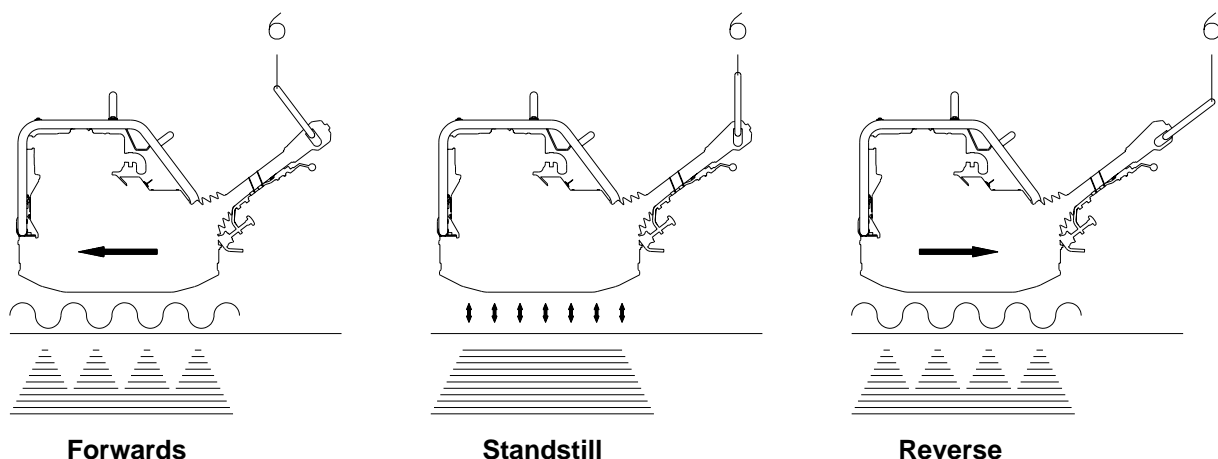

Switching off

ATTENTION! Never switch off the engine with the automatic decompression (2) as this inevitably results in damage to the valve drive and decompression mechanism.

1. Move the throttle control lever (8) to the stop.
2. When the engine is at a standstill, turn the ignition key (22) to the Stop position and pull out, control lamp goes off.

Compaction without extension plates

If the vibration plates is used without extension plates, screw set of protective screws (8 pes) No. 0067519 into the threaded boreholes situated in the lower mass, in order to avoid threads from being damaged.

Emergency start by hand

An automatic decompression (2) is provided to facilitate starting. It ensures that there is only a little compression pressure during the first few revolutions of the crankshaft. After several revolutions it automatically switches over to the full compression pressure.

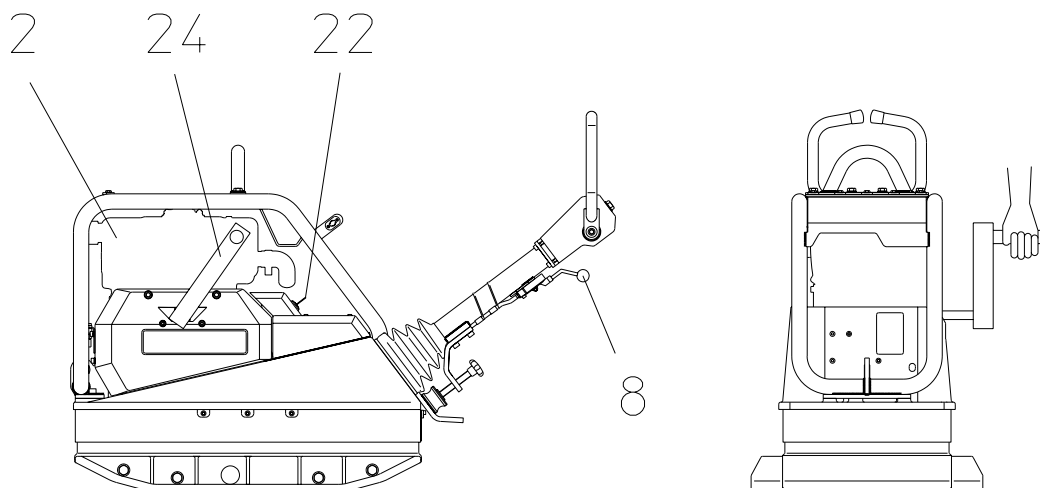

1. Turn the throttle control lever (8) to the full load position.
2. Following the direction of long arrow, turn the decompression lever until the stop position. At this point automatic decompression lever engages with an audible click, and the engine is ready to start.
3. Insert crank (24) into the bushing.
4. After having engaged the automatic decompression system to the stop position, the engine will require five full turns of the crank until the engine regains its compression and fires up. If for any reason less than five turns are required for the starting procedure, turn the decompression lever back in the direction of the short dashed arrow. Each audible „click“ of the mechanism is equivalent to one turn less with the crank.
5. Stand beside the engine (feet slightly apart), viewing in the forward direction.
6. Place one hand on the machine and crank with the other hand.

ATTENTION! Keep a firm hold of the crank while cranking in order to avoid the risk of sudden slip-page.

7. Turn crank slowly at first until crank engages and then increase cranking speed.
8. As soon as the engine is running, remove crank (24).
9. Throttle control lever (8) in idling position; allow engine to warm up at idling speed for 2 - 3 minutes.

Mechanical oil pressure control

It is necessary to reactivate the mechanical oil pressure control in the following cases:

- after the initial filling - first filling - of the fuel tank or if the tank has run dry.
- in the case of an automatic engine stop due to an inefficient engine oil supply.
- after freeing the engine when in presence of extremely low temperatures.

1. Fill up fuel tank.
2. Check engine oil level.
3. To activate depress hand lever „1“ for approx. 5 seconds.
4. Hold down pin „1“ during approx. 5 seconds in the case of encapsulated engine versions.
5. Simultaneously actuate hand lever a few times in the case of engines equipped with fuel pumps.
6. Complete engine. Check to see that encapsulating elements seal correctly.

ATTENTION! Check oil level every 8 to 15 operating hours in spite of the mechanical oil pressure control.

Starting with external battery etc.

Observe the following connection sequence when using an external battery to start the engine:

1. Connect one end of jumper cable to positive terminal of auxiliary battery.
2. Connect the other end of jumper cable to positive terminal of the vibro plate battery.
3. Now connect jumper cable clamp to negative terminal of the auxiliary battery.
4. Connect other end of jumper cable to the upper mass of the vibratory plate, e.g. to the motor fixing screws. The connection point should be as far away as possible from the battery of the vibratory plate.
5. Disconnect jumper cable in reverse order.

ATTENTION! Only 12 V batteries may be used. The use of e.g. a 24 V truck battery will lead to an explosion of the vibro plate battery!

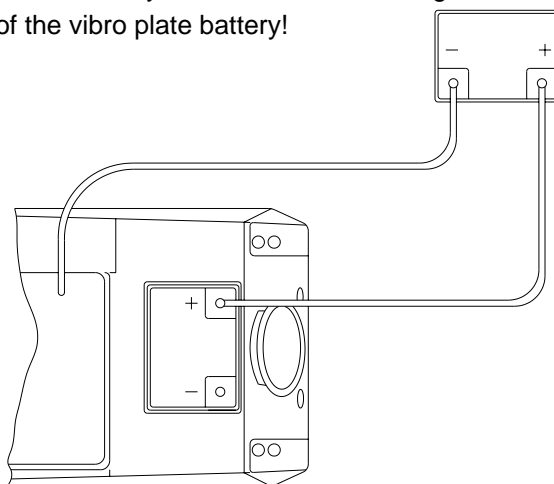

Additional notes on starting at very low temperatures!

ATTENTION! Never use starting sprays or similar - they are forbidden because they are dangerous. Only use original Wacker crank.

ATTENTION! If cranking, is too slow, the engine can start running in the opposite direction of rotation. In this case the air is drawn in through the exhaust and the exhaust gases escape through the air filter. Risk of fire! Switch off engine and start it again.

In case of a manual start: Free the engine by turning it approximately 10 to 20 times with the decompression lever in a central position. Then the engine is decompressed, but not ready to start. This intermediate position is used to turn the engine "free" when at very low temperatures. The turning resistance becomes appreciably lower owing to the change in viscosity of the oil film. At the same time you will hear that the nozzle of the fuel injection system is injecting cleanly (rattling).

At very low temperatures (below -5°C , use the starting oil dosing device (23).

Note: Do not use more than 2 doses as otherwise there is a risk of crank back-swing.

Maintenance schedule

Component	Maintenance work	Maintenance interval
External hardware	Check for tightness.	approx. 8 hours after initial start-up
Drive engine	First oil change and filter.	25 hours after initial start-up
Air filter Drive engine	Check dry type air filter - clean or replace filter cartridge if necessary (pay attention to the maintenance indication). Check oil level, if nec. top up oil.	daily
Centre pole height setting, transport lock	Regrease.	weekly
V-belt Protective frame, central lifting point Tow-bar head	Check V-belt, if. nec. replace. Check attachment screws for tight fit. Check oil level, top up if necessary.	monthly
Drive engine Exciter Battery Valve clearance	Oil change, change oil filter. Keep cooling fins free of dirt, clean dry. Retighten all accessible screw connections. Oil change. Check acid level, if nec. top up with distilled water. Check, set to when engine is cold. Inlet valve 0,1 mm - outlet valve 0,2 mm.	every 250 h
Fuel filter	Change filter.	every 500 h

Engine oil

Check oil level:

Check oil level on oil dipstick (21). If the oil level is too low, top up with HD brand oil SAE 10 W 40 through the filler nozzle (19).

Changing the oil:

1. Let engine warm up.
2. Loosen oil drain screw.
3. Loosen fastening screws and place bracket over used oil container.
4. Remove oil drain screw and pour oil into container.
5. Screw oil drain screw back in and refasten bracket.
6. Pour in 1,0 l of oil through the filler nozzle (19).

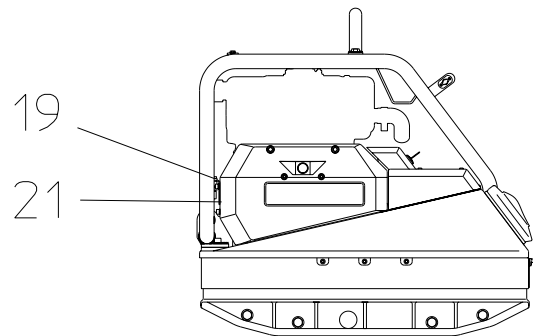

Battery

Check acid level:

1. Remove battery cover.
2. Check acid level, if necessary top up with distilled water.
3. Secure battery cover.

ATTENTION! Do not close venting opening!

Note: Only replace defective batteries with original Wacker batteries. Standard batteries are not suitable for the high vibration loads.

4. When changing the battery:
 - Removal: First disconnect negative, then positive terminal of battery.
 - Assembly: First connect positive, then negative terminal of battery.
 - When using starting sprays etc., see chapter operation.

Hydraulic control

Check oil level:

1. Move centre pole into vertical position.
2. Open filler bore (26).
3. Oil level must be at mark, if necessary top up with hydraulic oil Fuchs Renolin MR 520.
4. Close filler bore (26).

Venting hydraulic control:

1. Remove apron (28) by undoing the screws (29).
2. Move centre pole into vertical position, move shift lever (6) right into the reverse position, open filler bore (26).
3. Loosen connecting screw (27).
4. Slowly push the shift lever (6) into forward motion direction until hydraulic oil emerges bubblefree at the connection screw.
5. Tighten connecting screw (27), mount apron (28).
6. If necessary, top up with Fuchs Renolin MR 520, seal filler bore (26).

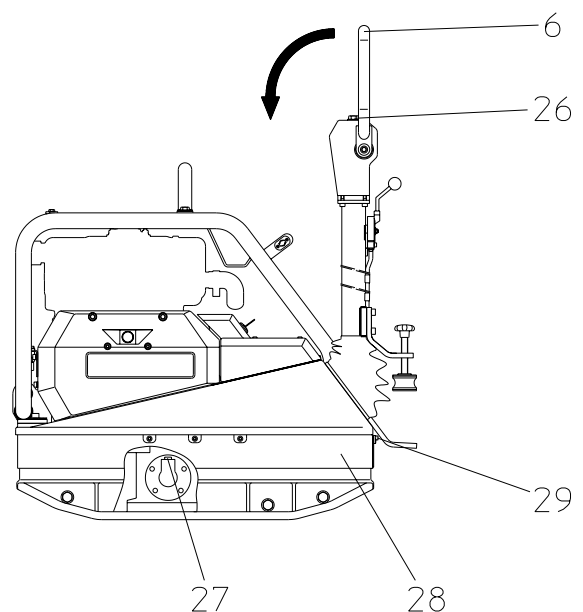

Exciter

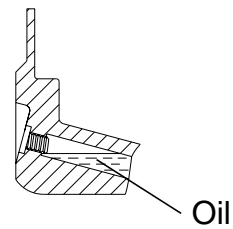
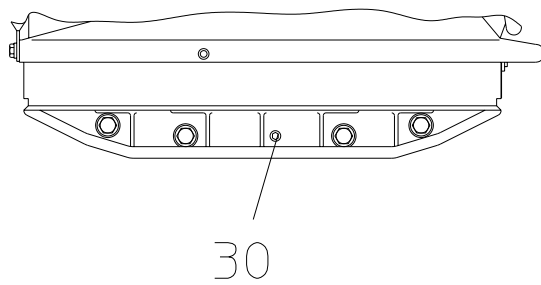

Check oil level:

1. Position vibration plate horizontally.
2. Open filler bore (30).
3. The oil level must reach the start of the thread of the filler bore (30).
4. If necessary, pour in HD brand oil SAE 10 W 40 through filler bore (30) (use funnel 0,75 l).
5. Close filler bore (30).

Changing the oil:

1. Open filler bore (30).
2. Tilt vibration plate and keep it tilted until the oil has run out.
3. Place vibration plate in horizontal position.
4. Pour in 0,75 l HD brand oil SAE 10 W 40 through the filler bore (30).
5. Close filler bore (30).

ATTENTION! Do not pour in too much oil!

Exciter V-belt

It is not necessary to retighten the V-belt owing to the use of the automatic centrifugal clutch.

Should the V-belt width fall below 15,5 mm the V-belt must be replaced.

Changing the exciter V-belt:

1. Remove belt guard (31).
2. Undo screw (32).
3. Remove button (33), belleville spring (34), seal (35) and front segment of the V-belt pulley (10).
4. Change exciter V-belt (12).
5. Assemble the components in reverse order; make sure that the coloured marking on the pin (36) coincides with the marking on the V-belt pulley (10)

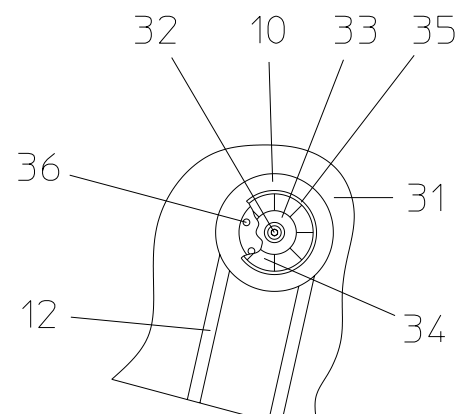

ATTENTION! Do not oil or grease clutch components (will damage the graphite bushes).

Forward speed too low

- Cause: - Too little hydraulic oil in the centre pole head.
 - Air in hydraulic control.
- Remedy: - Top up hydraulic oil.
 - Bleed system.

Reverse speed too low

- Cause: - Too much oil in centre pole head.
- Remedy: - Correct oil level in accordance with mark.

No reverse motion

- Cause: - Mechanical fault.
- Remedy: - Contact Wacker service dept.

Loss of hydraulic oil

- Cause: - Leaks, hydraulic hose defective.
- Remedy: - Change defective parts.
Note: Bleed system after every dismantling operation.

Battery-charge warning lamp does not go off

- Cause: - Dynamo defective.
 - Control unit defective.
- Remedy: - Contact Wacker service dept.
 - Replace control unit (on rear of the dynamo).

Engine does not start

- Cause: - Ignition lock defective.
 - Starter defective.
 - Start knob defective.
 - Battery flat.
 - Lack of lubricating oil.
- Remedy: - Change defective parts.
 - Charge battery.
 - Fill up with oil and actuate valve lever at oil filter housing once.

EC - CONFORMITY-CERTIFICATE

Wacker-Werke GmbH & Co. KG , Preußenstraße 41, 80809 München

hereby certify that the construction equipment specified hereunder:

1. Category: **Vibratory plate**
2. Type: **DPU 5045H**
3. Equipment item number: **0007862 ...**
4. absolute installed power: **6,1 kW**

has been evaluated in conformity with Directive 2000/14/EC:

Conformity assessment procedure	At the following notified body	Measured sound power level	Guaranteed sound power level
Annex VIII	VDE Prüf- und Zertifizierungsinstitut Zertifizierungsstelle Merianstraße 28 63069 Offenbach/Main	107 dB(A)	108 dB(A)

and has been manufactured in accordance with the following directives:

2000/14/EG
EMV - Richtlinie 89/336/EG
98/37/EG
EN 500-1
EN 500-4

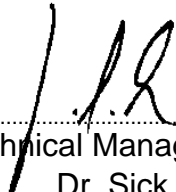
.....
Technical Management
Dr. Sick

File certificate carefully



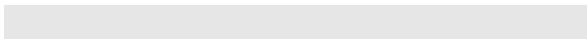
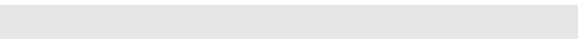
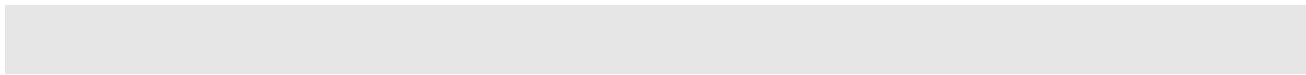

VDE Prüf- und Zertifizierungsinstitut

VDE VERBAND DER ELEKTROTECHNIK
ELEKTRONIK INFORMATIONSTECHNIK e.V.

C E R T I F I C A T E

Registration Number 6236 / QM / 06.97 (AB)

This is to certify that the company

WACKER



Wacker-Werke GmbH & Co. KG

located at

**Munich plant
Preussenstr. 41
80809 München**

**Reichertshofen plant (AB)
Karlsfeld logistics Centre**

Branches and service depots all over Germany

has implemented and maintains a
Quality System for the following scope

**Machine manufacture
Construction machines**

This Q System complies with the requirements of

DIN EN ISO 9001:1994

This Certificate is valid until 05.06.2003

VDE Testing and Certification Institute
Certification

D-63069 Offenbach/Main, Merianstraße 28
Date 14.06.2000

The VDE Testing and Certification Institute is accredited by DAR Accreditation Bodies
according to DIN EN 45012 and notified in the EU under ID. No. 0366.



